

The Southwest and Buzzard Point Flood Resilience Strategy aims to establish a Blue-Green Infrastructure network to safeguard these neighborhoods against flooding from extreme rain events. Utilizing open spaces and streets enhances flood resilience and offers additional benefits like improved parks, increased greenery, cooler summer temperatures, and safer streets for residents.

Given the projected increase in frequency and severity of extreme rain events due to climate change, addressing this issue is crucial, especially for communities with large public housing developments and vulnerable populations. Consequently, the District of Columbia must adopt innovative stormwater management strategies and prioritize open space Initiatives.

During the strategy's development phase from March 2022 to June 2023, the District's planning team and private consultants engaged with residents, local stakeholders, and District and Federal Agencies through three milestone workshops to gather feedback. Additionally, this process involved creating conceptual designs for Lansburgh Park, which was identified as a pilot project. Geographic Information System (GIS) data serve as the study's cornerstone, providing essential information for informed decision-making.





Daily Dry Conditions

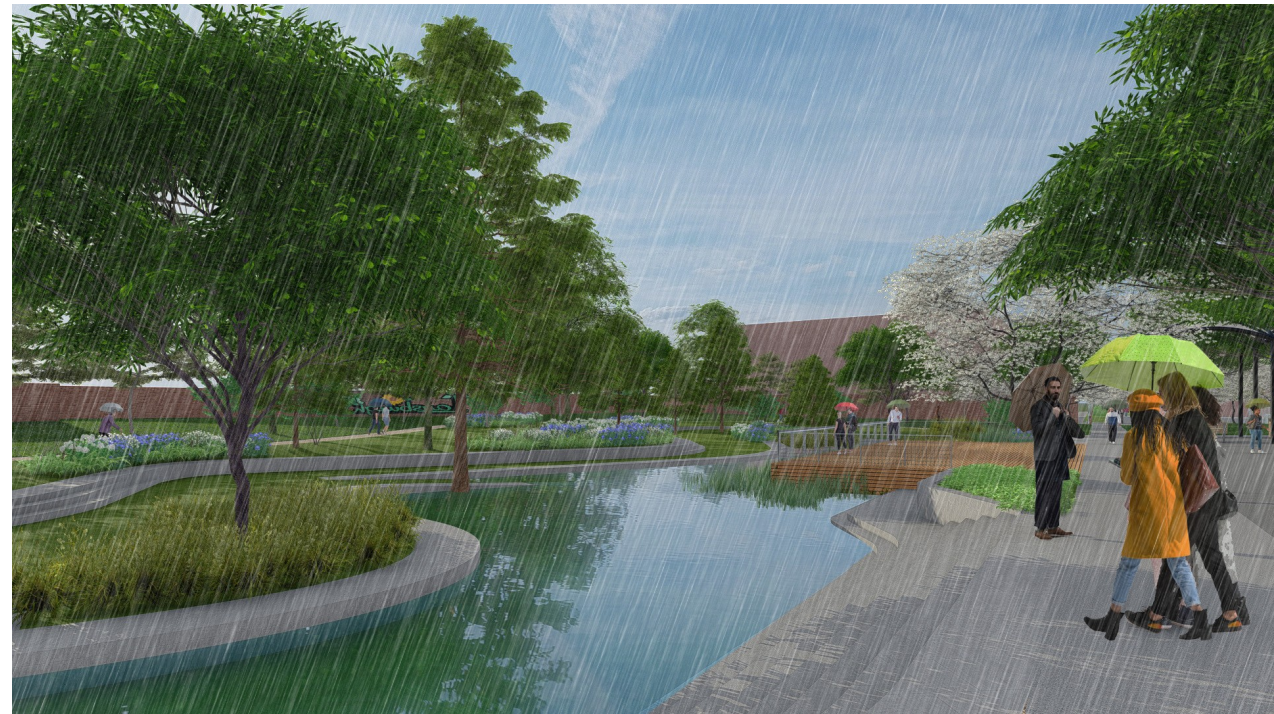

Storm Conditions (A 20-year event in 2080s climate conditions)





ASLA
POTOMAC
2024 Awards

Southwest and Buzzard Point Flood Resilience Strategy

Moody Graham

Contributions

Landscape
Architect



Ryan Moody, Principal

Hibiki Zhao, Associate

Meredith Ver Steeg, Associate



Acknowledgements

- Metropolitan (DDOT)
- DC Department of Parks and Recreation (DPR)
- DC Office of Planning (DCOP)
- District Department of Energy and Environment (DOEE)
- District Department of Homeland Security and Emergency Management Agency (HSEMA)
- DC Housing Authority (DCHA)
- DC Water
- Washington Metropolitan Area Transit Authority (WMATA)
- National Capital Planning Commission (NCPC)
- National Park Service (NPS)
- Commission of Fine Arts
- US Army Corps of Engineers (USACE)
- US Army

Planning Team



Jeffrey Seltzer
Deputy Director
Natural Resources Administration

Meredith Upchurch, PE, ASLA, SITES AP
Associate Director
Regulatory Review Division

Nicholas Bonard
Branch Chief
Floodplains, Wetlands, and Groundwater
Regulatory Review Division

Andrea Limauro
Environmental Protection Specialist, Resilience
Focus Areas

Lily Cheng, LEED AP, CPHD
Environmental Protection Specialist

Consultant Team



Southwest and Buzzard Point Flood Resilience Strategy
Moody Graham